

**POS. 11 STAHLBETONDECKE '10B'**

## SYSTEM UND BELASTUNG

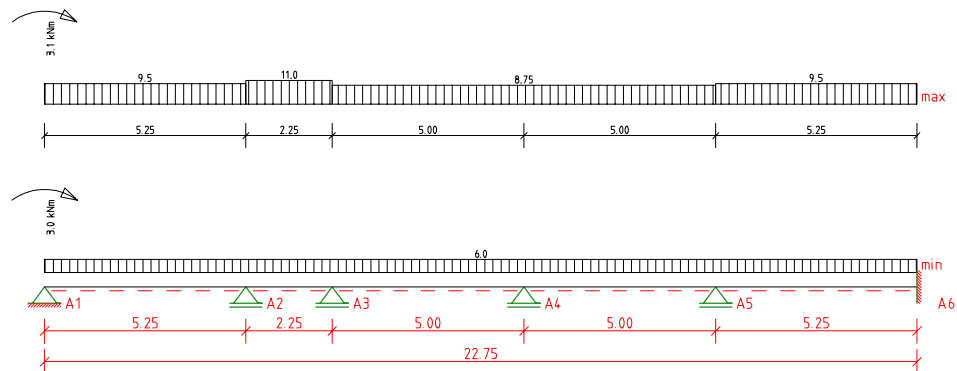

$$\begin{aligned}
 \text{Stahlbeton } 18 \text{ cm} & * 0.25 & = & 4.50 \text{ kN/m}^2 \\
 \text{Putz und Belag} & & = & 1.50 \text{ kN/m}^2 \\
 \hline
 g & = & 6.00 \text{ kN/m}^2
 \end{aligned}$$

$$\text{aus Pos. 1 A1} \qquad M_{li} = 3.1 / 3.0 \text{ kNm/m}$$

Feld 1	l = 5.25 m	p = 3.50 kN/m <sup>2</sup>
Feld 2	l = 2.25 m	p = 5.00 kN/m <sup>2</sup>
Feld 3	l = 5.00 m	p = 2.75 kN/m <sup>2</sup>
Feld 4	l = 5.00 m	p = 2.75 kN/m <sup>2</sup>
Feld 5	l = 5.25 m	p = 3.50 kN/m <sup>2</sup>

$$\text{Einspannung rechts} \qquad \text{max / min} = 60 / 40 \%$$

## AUFLAGERBEDINGUNGEN

Stütze	1	2	3	4	5	6 .
Art	Mwk	Stb	Stb	Stb	Stb	Stb
b (cm)	36.5	24.0	24.0	24.0	24.0	24.0

## SCHNITTGRÖSSEN

max A1 = 19.87 kN/m	min Ms1 = 3.10 kNm/m
min A1 = 12.01 kN/m	max Ms1 = 3.00 kNm/m
max Mf1 = 23.84 kNm/m	min Mf1 = 15.06 kNm/m
max A2 = 51.79 kN/m	min Ms2 = -25.32 kNm/m
min A2 = 26.95 kN/m	max Ms2 = -14.82 kNm/m
max Mf2 = 2.32 kNm/m	min Mf2 = -10.89 kNm/m
max A3 = 32.97 kN/m	min Ms3 = -13.43 kNm/m
min A3 = 9.70 kN/m	max Ms3 = -3.94 kNm/m
max Mf3 = 14.08 kNm/m	min Mf3 = 7.10 kNm/m

max A4 = 47.95 kN/m	min Ms4 = -21.73 kNm/m
min A4 = 29.03 kN/m	max Ms4 = -11.69 kNm/m
max Mf4 = 11.18 kNm/m	min Mf4 = 1.60 kNm/m
max A5 = 50.18 kN/m	min Ms5 = -22.97 kNm/m
min A5 = 27.46 kN/m	max Ms5 = -10.34 kNm/m
max Mf5 = 18.41 kNm/m	min Mf5 = 3.66 kNm/m
max A6 = 25.45 kN/m	min Ms6 = -19.64 kNm/m
min A6 = 15.13 kN/m	max Ms6 = -13.09 kNm/m

**B E M E S S U N G**

Beton B 25, Stahl BSt 500 M

Decke d = 18 cm

Betondeckung 1.5 cm

Stütze 1	Ms' = 3.10 kNm/m	ms = 0.7 % oben	as = 0.69 cm <sup>2</sup> /m Matten R 131
Feld 1		ms = 5.3 % unten	as = 5.58 cm <sup>2</sup> /m Matten R 589
Stütze 2	Ms' = -22.74 kNm/m	ms = 5.0 % oben	as = 5.31 cm <sup>2</sup> /m Matten R 589
Feld 2		ms = 0.5 % unten	as = 0.51 cm <sup>2</sup> /m Matten R 131
Stütze 3	Ms' = -12.07 kNm/m	ms = 2.6 % oben	as = 2.74 cm <sup>2</sup> /m Matten R 317
Feld 3		ms = 3.1 % unten	as = 3.21 cm <sup>2</sup> /m Matten R 377
Stütze 4	Ms' = -18.91 kNm/m	ms = 4.2 % oben	as = 4.38 cm <sup>2</sup> /m Matten R 443
Feld 4		ms = 2.4 % unten	as = 2.53 cm <sup>2</sup> /m Matten R 257
Stütze 5	Ms' = -20.16 kNm/m	ms = 4.4 % oben	as = 4.68 cm <sup>2</sup> /m Matten R 513
Feld 5		ms = 4.1 % unten	as = 4.26 cm <sup>2</sup> /m Matten R 443
Stütze 6	Ms' = -19.64 kNm/m	ms = 4.3 % oben	as = 4.56 cm <sup>2</sup> /m Matten R 513
Tau 0 = 30.33 / 8.5 / 16.1		= 0.22	N/mm <sup>2</sup> <= 0.35 N/mm <sup>2</sup>
li / h = 0.80 * 525 / 16.1		= 26.1	<= 35.0